

**DATA SHEET
#SPS503**

WIDE ANGLE “AUTO-SPRAY” NOZZLES

“Auto-Spray” Wide Angle Nozzles

MODELS: Type WA - 120° Pattern “Auto-Spray” Wide Angle Nozzle, Full Cone, High Velocity, Directional

APPROVALS: UL Listed and FM Approved

TO SPECIFY: Furnish and install “Automatic” Sprinkler brand “Auto-Spray Wide Angle Nozzle

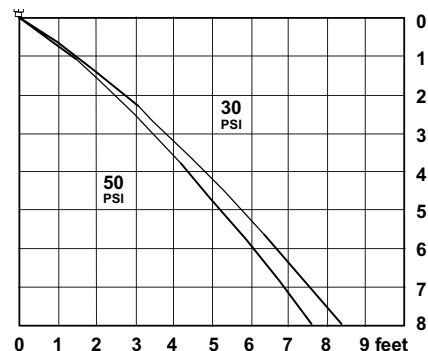

DESIGN FEATURES: “AUTO-SPRAY” is the most efficient method of applying water on such fires involving flammable liquids or solids that are violent and stubborn to extinguish. Ordinary methods of fire protection are not effective. The Auto-Spray nozzle provides a high velocity directional spray. It is designed to impart sufficient velocity to the water spray to prevent dissipation of discharge before it reaches the surface to be protected. Interior spiral deflectors and a center jet break the water into a directional full cone spray.

“AUTO-SPRAY” NOZZLES are designed for use with deluge-type systems operated by separate detection, such as rate-of-rise, vapor, smoke, electronic or photo-electric detection units. They do not employ a fusible link arrangement.

Possible objectives of an “AUTO-SPRAY” system as per NFPA #15 are:

- a). Extinguishment of fire.
- b). Control of burning.
- c.) Exposure protection
- d.) Prevention of fire.

“AUTO-SPRAY” is designed to satisfy these objectives by producing a coherent, uniform pattern which can be aimed at the specific area to be protected.

“AUTO-SPRAY” NOZZLES have relatively large water ways which make clogging from foreign material unlikely. It is therefore not necessary to remove and clean each nozzle after operation. A self-cleaning “AUTO-SPRAY” strainer is normally installed in the water supply line to prevent any foreign material from entering the system.

The internal construction of the “AUTO-SPRAY” NOZZLE is such that a stream of water entering the nozzle is split into two segments. The first segment is directed by turbine vanes at the second segment, which flows straight through the nozzle in such a way that a controlled turbulence is produced at the orifice and breaks up the stream. The arrangement and number of these internal vanes produces the great variety of available patterns, and also atomizes the water spray so that uniform discharge throughout the pattern can be achieved.

“AUTO-SPRAY” NOZZLES SUBMITTAL SHEET

WIDE ANGLE “AUTO-SPRAY” NOZZLE - TYPE WA - 120° PATTERN

Medium Angle type “AUTO-SPRAY” NOZZLES produce a conical pattern 120° in diameter and are available in FOUR orifice sizes. These nozzles are available for 1” and 1-1/4” pipe connections.

Nozzle No.	Pipe Conn. (Male)	Orifice K Factor	Flow Rate in gpm for given psi										
			10	15	20	30	40	50	60	70	80	90	100
10 WA	1”	1.8	5.7	7.0	8.0	9.9	11.4	12.7	13.9	15.1	16.1	17.1	18.0
14 WA	1”	2.6	8.2	10.1	11.6	14.2	16.4	18.4	20.1	21.8	23.3	24.7	26.0
18 WA	1-1/4”	3.3	10.4	12.8	14.8	18.1	20.9	23.3	25.6	27.6	29.5	31.3	33.0
29 WA	1-1/4”	5.3	16.8	20.5	23.7	29.0	33.5	37.5	41.1	44.3	47.4	50.3	53.0

WIDE ANGLE NOZZLE

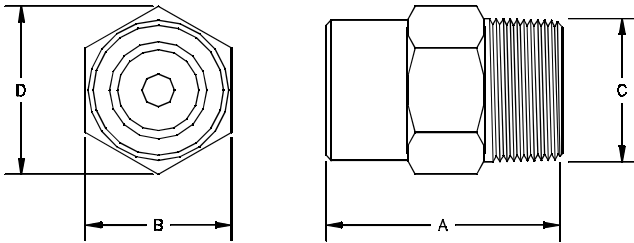

DISCHARGE CHARACTERISTIC

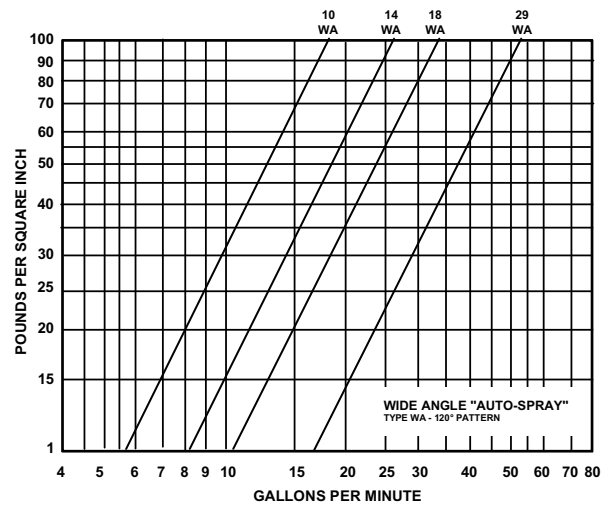

PHYSICAL CHARACTERISTICS				
Nozzle No.	Dimensions			
	A	B	C	D
10 WA	2-3/16	1-5/16	1	1-17/32
14 WA	2-3/16	1-5/16	1	1-17/32
18 WA	2-5/8	1-11/16	1-1/4	1-15/16
29 WA	2-5/8	1-11/16	1-1/4	1-15/16

ORDERING INFORMATION

Nozzle Number	Type	Pipe Conn. Male	Angle of Pattern	Inventory Code No.	Order (Check One)
10 WA	Wide Angle	1	120°	1415063	
14 WA	Wide Angle	1	120°	1415064	
18 WA	Wide Angle	1-1/4	120°	1415069	
28 WA	Wide Angle	1-1/4	120°	1415070	

This information is only a general guideline. The company reserves the right to change any portion of this information without notice. Terms and conditions of sale apply and are available on request.

12/00 Printed in USA SPS400Q