

**DATA SHEET
#SPS502**

“AUTO-SPRAY” NOZZLES NARROW ANGLE

“Auto-Spray” Narrow Angle Nozzles

MODELS: Type NA - 60° Pattern “Auto-Spray” Narrow Angle Nozzle, Full Cone, High Velocity, Directional

APPROVALS: UL Listed and FM Approved

TO SPECIFY: Furnish and install “Automatic” Sprinkler brand “Auto-Spray Narrow Angle Nozzle.

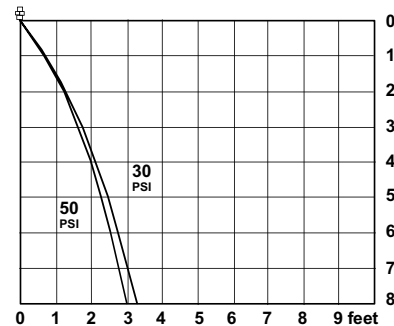

DESIGN FEATURES: “AUTO-SPRAY” is the most efficient method of applying water on such fires involving flammable liquids or solids that are violent and stubborn to extinguish. Ordinary methods of fire protection are not effective. The Auto-Spray nozzle provides a high velocity directional spray. It is designed to impart sufficient velocity to the water spray to prevent dissipation of discharge before it reaches the surface to be protected. Interior spiral deflectors and a center jet break the water into a directional full cone spray.

“AUTO-SPRAY” NOZZLES are designed for use with deluge-type systems operated by separate detection, such as rate-of-rise, vapor, smoke, electronic or photo-electric detection units. They do not employ a fusible link arrangement.

Possible objectives of an “AUTO-SPRAY” system as per NFPA #15 are:

- a). Extinguishment of fire.
- b). Control of burning.
- c.) Exposure protection
- d.) Prevention of fire.

“AUTO-SPRAY” is designed to satisfy these objectives by producing a coherent, uniform pattern which can be aimed at the specific area to be protected.

“AUTO-SPRAY” NOZZLES have relatively large water ways which make clogging from foreign material unlikely. It is therefore not necessary to remove and clean each nozzle after operation. A self-cleaning “AUTO-SPRAY” strainer is normally installed in the water supply line to prevent any foreign material from entering the system.

The internal construction of the “AUTO-SPRAY” NOZZLE is such that a stream of water entering the nozzle is split into two segments. The first segment is directed by turbine vanes at the second segment, which flows straight through the nozzle in such a way that a controlled turbulence is produced at the orifice and breaks up the stream. The arrangement and number of these internal vanes produces the great variety of available patterns, and also atomizes the water spray so that uniform discharge throughout the pattern can be achieved.

“AUTO-SPRAY” NOZZLES SUBMITTAL SHEET

NARROW ANGLE “AUTO-SPRAY” NOZZLE - TYPE NA - 60° PATTERN

Narrow Angle type “AUTO-SPRAY” NOZZLES produce a conical pattern 60° in diameter and are available in six orifice sizes. These nozzles are available for 3/4” pipe connections.

Nozzle No.	Pipe Conn. (Male)	Orifice K Factor	Flow Rate in gpm for given psi										
			10	15	20	30	40	50	60	70	80	89	100
5 NA	3/4"	.9	2.8	3.5	4.0	4.9	5.7	6.4	7.0	7.5	8.0	8.5	9.0
7 NA	3/4"	1.2	3.8	4.6	5.4	6.6	7.6	8.5	9.3	10.0	10.7	11.4	12.0
8 NA	3/4"	1.4	4.4	5.4	6.3	7.7	8.9	9.9	10.8	11.7	12.5	13.3	14.0
10 NA	3/4"	1.8	5.7	7.0	8.0	9.9	11.4	12.7	13.9	15.1	16.1	17.1	18.0
12 NA	3/4"	2.2	7.0	8.5	9.8	12.0	13.9	15.6	17.0	18.4	19.7	20.9	22.0
14 NA	3/4"	2.6	8.2	10.1	11.6	14.2	16.4	18.4	20.1	21.8	23.3	24.7	26.0

Narrow Angle “AUTO-SPRAY” Nozzle

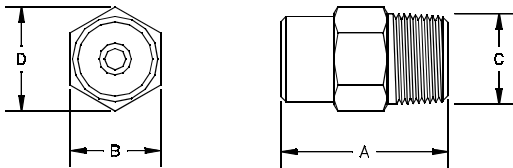

Nozzle No.	Physical Characteristics			
	Dimensions			
	A	B	C	D
5 NA	1 7/8	1 1/16	3/4	1 7/32
7 NA	1 7/8	1 1/16	3/4	1 7/32
8 NA	1 7/8	1 1/16	3/4	1 7/32
10 NA	1 7/8	1 1/16	3/4	1 7/32
12 NA	1 7/8	1 1/16	3/4	1 7/32
14 NA	1 7/8	1 1/16	3/4	1 7/32

Discharge Characteristics

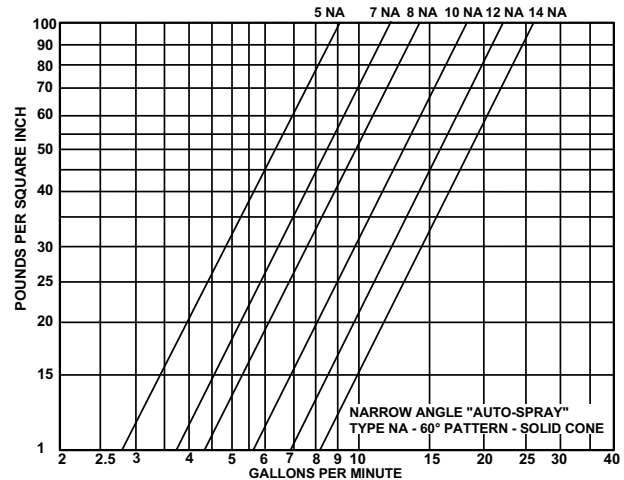

ORDERING INFORMATION:

Nozzle Number	Type	Pipe Conn. Male	Angle of Pattern	Inventory Code No.	Order (Check One)
5 NA	Narrow Angle	3/4	60°	1415050	
7 NA	Narrow Angle	3/4	60°	1415051	
8 NA	Narrow Angle	3/4	60°	1415052	
10 NA	Narrow Angle	3/4	60°	1415053	
12 NA	Narrow Angle	3/4	60°	1415054	
14 NA	Narrow Angle	3/4	60°	1415055	

This information is only a general guideline. The company reserves the right to change any portion of this information without notice. Terms and conditions of sale apply and are available on request.

12/00 Printed in USA SPS400Q