



Pressure Gauges

Fire Protection, Sprinkler Service Gauge Type 1005P, XUL Grade B (3-2-3%)

- Underwriters Laboratory listed and Factory Mutual approved
- Corrosion-resistant ABS case
- Heat-resistant polycarbonate push-in window
- Patented PowerFlex™ movement with polyester segment
- True Zero™ indication, a unique safety feature

Ashcroft® fire protection sprinkler gauges are Underwriters Laboratory listed and Factory Mutual approved for fire protection sprinkler service. The case material on Type 1005P, XUL gauges is ABS. The 0-300 psi pressure range is used on “wet” systems where water is available to the sprinkler heads. The 0-80 retard to 250 psi pressure range is used on dry systems where the lines are filled with air pressure until system activation.

The patented PowerFlex movement with polyester segment is designed to provide unequalled shock and vibration resistance resulting in superior performance and extended gauge life.



True Zero indication, a standard feature on these gauges, reduces the potential risk of installing a damaged gauge on your equipment.

GAUGE SPECIFICATIONS

Type no.:	1005P, XUL	Connection:	¼ NPT lower
Size:	3½"	Ranges:	0-300 psi (water) 0-80 retard to 250 psi (air) UL 393 Listed, UL of Canada Listed and FM approved. Equivalent (single or dual scale) metric scales are available
Case:	ABS (Polycarbonate blend)		
Ring:	None		
Window:	Polycarbonate, push-in		
Dial:	Black figures on white background		
Pointer:	Black, aluminum		
Bourdon tube:	“C” shaped bronze		
Movement:	Patented PowerFlex with polyester segment		
Socket:	Brass		
Restrictor:	None		
Operating temperature:	-40°F to 150°F		

GAUGE OPTIONS

- Customized dials
- Other UL listed ranges on application

NOTES



MADE IN U.S.A.

TO ORDER THESE TYPE 1005P, XUL GAUGES:

Select:	35	W	1005	P	H	02L	XUL	300 #
1. Dial Size: 3½"	_____	_____	_____	_____	_____	_____	_____	_____
2. Patented PowerFlex™ Movement	_____	_____	_____	_____	_____	_____	_____	_____
3. Case Type Number: 1005	_____	_____	_____	_____	_____	_____	_____	_____
4. Case Type Material: ABS	_____	_____	_____	_____	_____	_____	_____	_____
5. Socket Material: Brass	_____	_____	_____	_____	_____	_____	_____	_____
6. Connection Size/Location: ¼ NPT lower	_____	_____	_____	_____	_____	_____	_____	_____
7. UL listed, FM approved	_____	_____	_____	_____	_____	_____	_____	_____
8. Range: 300 psi	_____	_____	_____	_____	_____	_____	_____	_____



**Fire Protection
Sprinkler Service Gauge
Type 1005, XUL – 3½"**

Dimensions

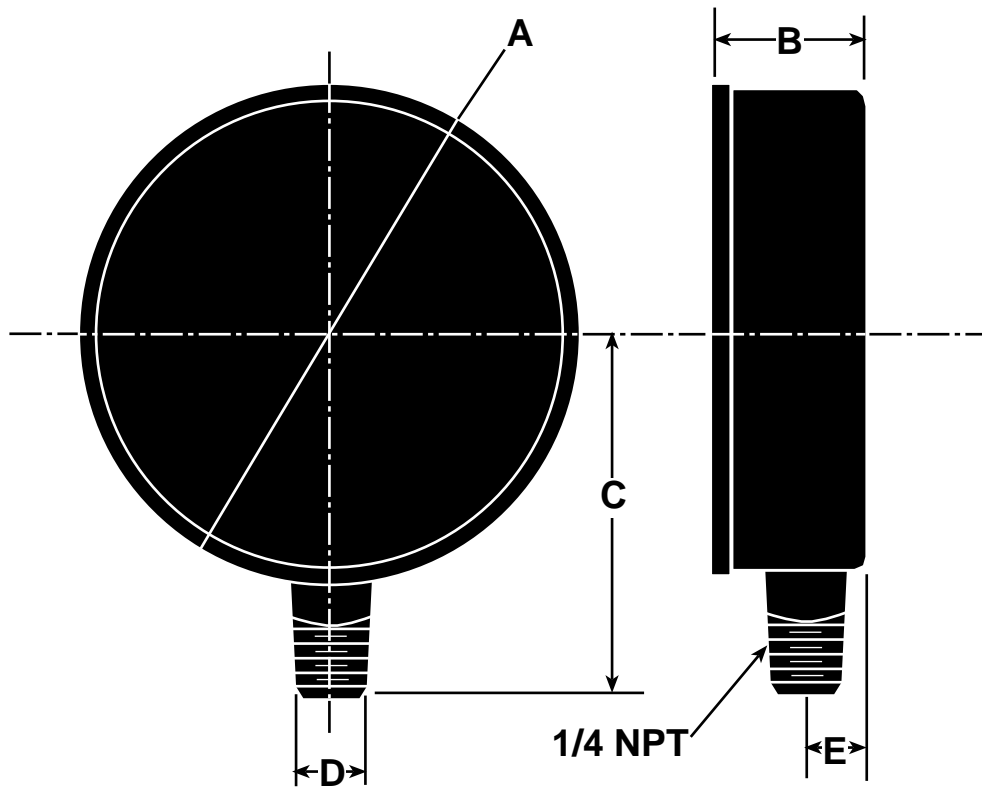

Size/Type		A	B	C	D	E
3½" 1005P XUL	inch	3.70	1.14	0.72	0.56	0.47
	mm	(94)	(29)	(69)	(14.2)	(11.9)